

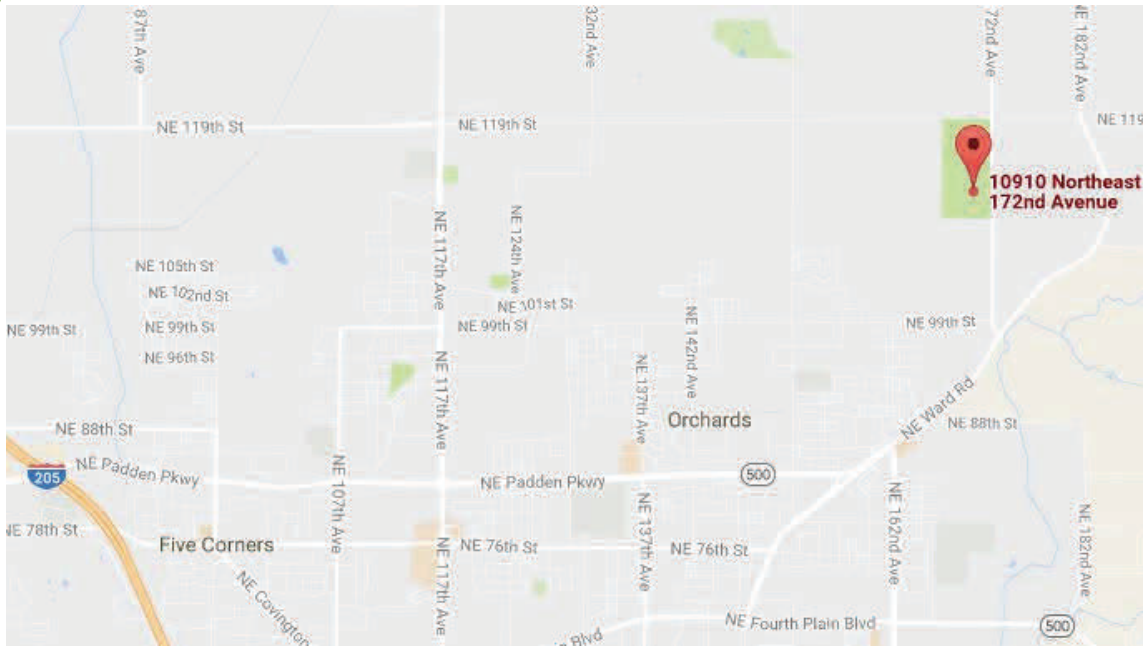

Hockinson Meadows Community Park



**10910 NE 172nd Ave
Brush Prairie, WA 98606**

From I-205:

Use Padden Parkway exit, east to NE 117th Avenue (Hwy 503). Left on NE 117th Avenue to NE 119th St. Right on NE 119th Street to NE 172nd Avenue. Right on NE 172nd Avenue approximately 1/2 mile to park entrance on the right.

One reservable shelter



Hockinson Meadows - Picnic Shelter

Inside Occupancy:	50
Outside Occupancy:	No outside seating
Senior and Wheelchair Access:	Yes
Distance to Parking Lot:	475 ft.
Distance to Restroom:	264 ft.
Near Playground/Nature Play:	Yes
Near Open Field:	Yes
Amenities:	Electricity (2-110v outlets), water fountain w/spigot, no grills, Four 10' picnic tables; four 7' picnic tables
Reservable:	Yes