

ROOF TYPES (Rafters w/ridge beam)

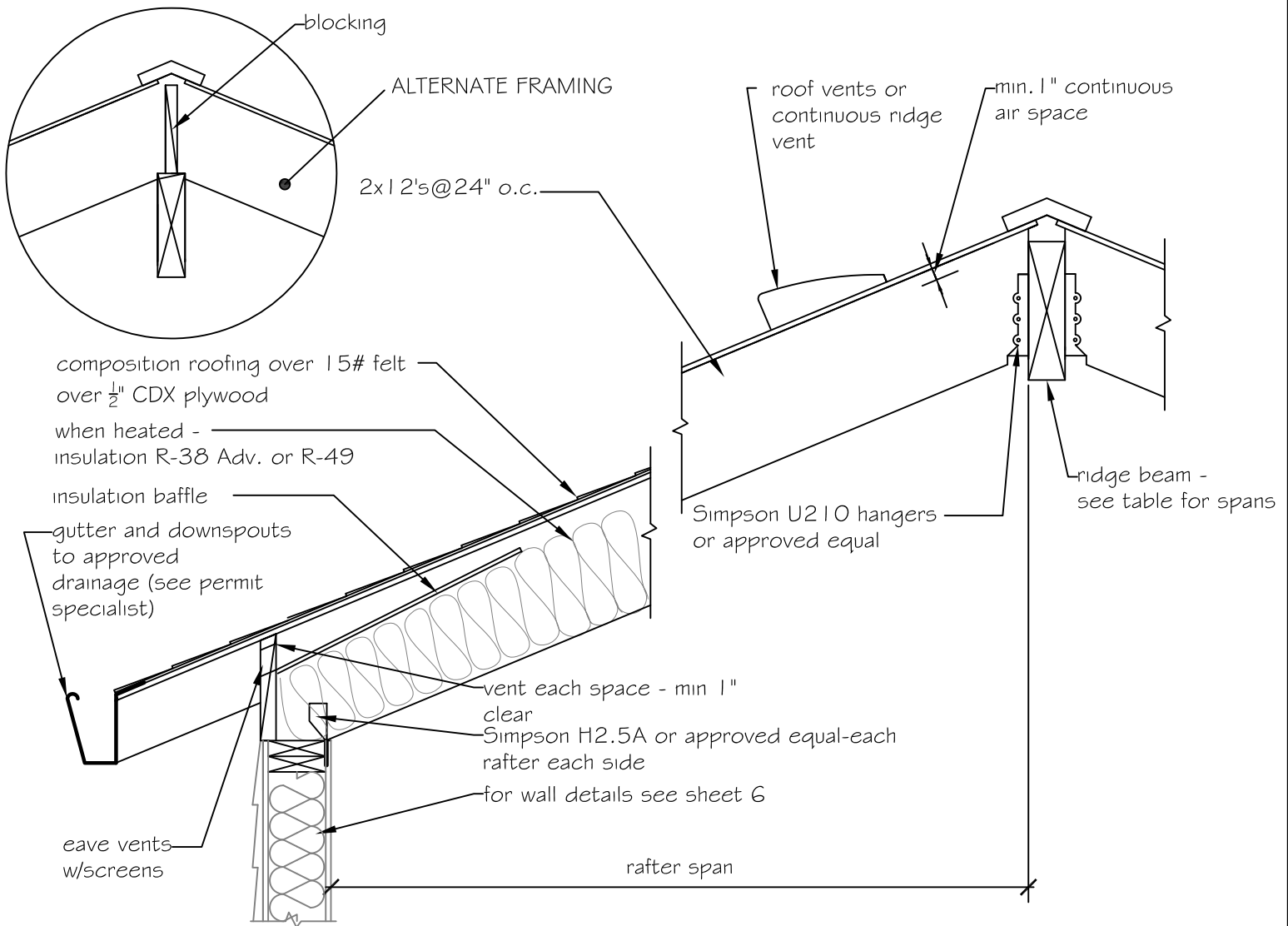

NOTES:

1. $3\frac{1}{8}$ ", $3\frac{1}{2}$ ", $5\frac{1}{8}$ ", $5\frac{1}{2}$ " and $6\frac{3}{4}$ " glu-lam beams
Fb = 2400
2. 2x, 4x and 6x Douglas Fir #2 unless otherwise noted.
3. Ridge beam to be supported by vertical wall or post to footings.

		Beam Span							
		10'-0"	12'-0"	14'-0"	16'-0"	18'-0"	20'-0"	22'-0"	24'-0"
Rafter Span	10'-0"	4 x 10	4 x 12	6 x 12 #1	$3\frac{1}{8}$ x $13\frac{1}{2}$	$3\frac{1}{8}$ x 18	$3\frac{1}{8}$ x $25\frac{1}{2}$	$3\frac{1}{2}$ x 24	$5\frac{1}{2}$ x 14
	12'-0"	4 x 12	6 x 12	6 x 14	$3\frac{1}{8}$ x 15	$3\frac{1}{8}$ x $22\frac{1}{2}$	$5\frac{1}{8}$ x $13\frac{1}{2}$	$5\frac{1}{8}$ x 14	$5\frac{1}{8}$ x 15
	14'-0"	4 x 14 #1	$3\frac{1}{8}$ x $10\frac{1}{2}$ 6 x 14	$3\frac{1}{8}$ x $13\frac{1}{2}$ 6 x 14 #1	$3\frac{1}{8}$ x 18	$3\frac{1}{2}$ x 18	$3\frac{1}{2}$ x $25\frac{1}{2}$	$5\frac{1}{8}$ x 15	$5\frac{1}{8}$ x 16
	16'-0"	6 x 12	6 x 14	$3\frac{1}{8}$ x 14 $5\frac{1}{8}$ x $9\frac{1}{2}$	$3\frac{1}{8}$ x 15 $5\frac{1}{8}$ x 12	$3\frac{1}{2}$ x 21 $5\frac{1}{8}$ x $13\frac{1}{2}$	$5\frac{1}{8}$ x $13\frac{1}{2}$	$5\frac{1}{8}$ x 16	$5\frac{1}{8}$ x 18
	18'-0"	6 x 12	6 x 16	$3\frac{1}{8}$ x 16 $5\frac{1}{8}$ x $10\frac{1}{2}$	$3\frac{1}{2}$ x $16\frac{1}{2}$ $5\frac{1}{8}$ x 12	$3\frac{1}{2}$ x 24 $5\frac{1}{8}$ x $13\frac{1}{2}$	$5\frac{1}{8}$ x 15 $5\frac{1}{2}$ x 14	$5\frac{1}{8}$ x $16\frac{1}{2}$ $5\frac{1}{2}$ x 16	$5\frac{1}{8}$ x $19\frac{1}{2}$ $5\frac{1}{2}$ x 18
	20'-0"								

1
8

ROOF FRAMING (VAULTED)

scale- $\frac{3}{4}$ " = 1'-0"