

File # CPZ2019-00003, SN 200326000 200355000

T3N R2E Sec 35







Preliminary Land Division

Owner: WELLS MARY ELLEN & DEMPSEY DIANNE



Information shown on this map was collected from several sources. Clark County accepts no responsibility for any inaccuracies that may be present.

Geographic Information System
 Printed on: May 23, 2019
 Project: e:\usr_proj\xx\OrdID226164_245470\AnnRev1.mxd ()

-  Subject Property
-  Zoning Boundary
-  Mining Combining District
-  Contingent Zoning
-  Urban Holding-10
-  Urban Holding-20

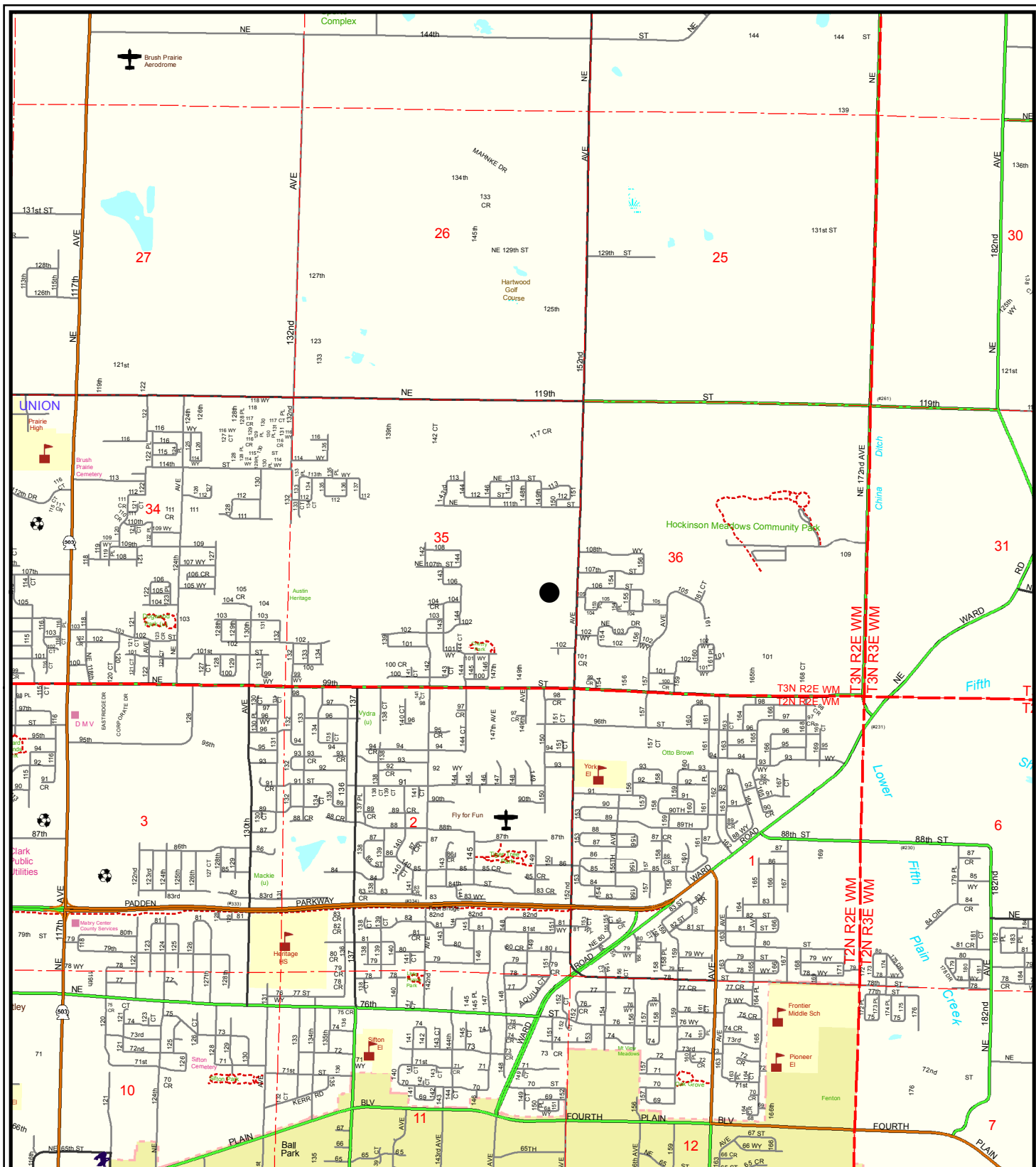

File # CP2019-00003, SN 200326000 200355000

T3N R2E Sec 35

Preliminary Land Division

Owner: WELLS MARY ELLEN & DEMPSEY DIANNE

● Subject Property Location



Information shown on this map was collected from several sources. Clark County accepts no responsibility for any inaccuracies that may be present.

Geographic Information System
 Printed on: May 23, 2019
 Project: e:\usr_proj\xxOrdID226164_245470\AnnRev3.mxd