

**CLARK COUNTY
STAFF REPORT**

DEPARTMENT: Community Development
DATE: December 16, 2014
REQUEST: Approve and sign the final plat for Padden Parkway
CHECK ONE: X Consent CAO

BACKGROUND: Transmitted for acceptance by the Board is the plat of Padden Parkway (PLD2014-00004/FLD2014-00037)

COMMUNITY OUTREACH: This land division received the standard land use review and approval process. Notice of application was mailed to the applicant, neighborhood association and property owners within 300 feet of the site on March 4, 2014.

BUDGET AND POLICY IMPLICATIONS: N/A

FISCAL IMPACTS

Yes (see attached form) No

ACTION REQUESTED: It is recommended the Board approve the short plat for the Oberreuter 68th Street Infill.

Zoning	Average Minimum lot size	Average Maximum lot size
R1-6	6,000	8,500
	Actual minimum lot size	Actual maximum lot size
	5,707	10,771

PROJECT START DATE: January 28, 2014 (preliminary plat application)

DISTRIBUTION: Please forward a copy of the approved staff report to Community Development.



Marty Snell
Community Development Director

Approved: 

CLARK COUNTY
BOARD OF COMMISSIONERS

Dec. 16, 2014
SR 291-14

Attachments: A (Vicinity Map)
B (Subdivision Map)







Attachment A Vicinity Map

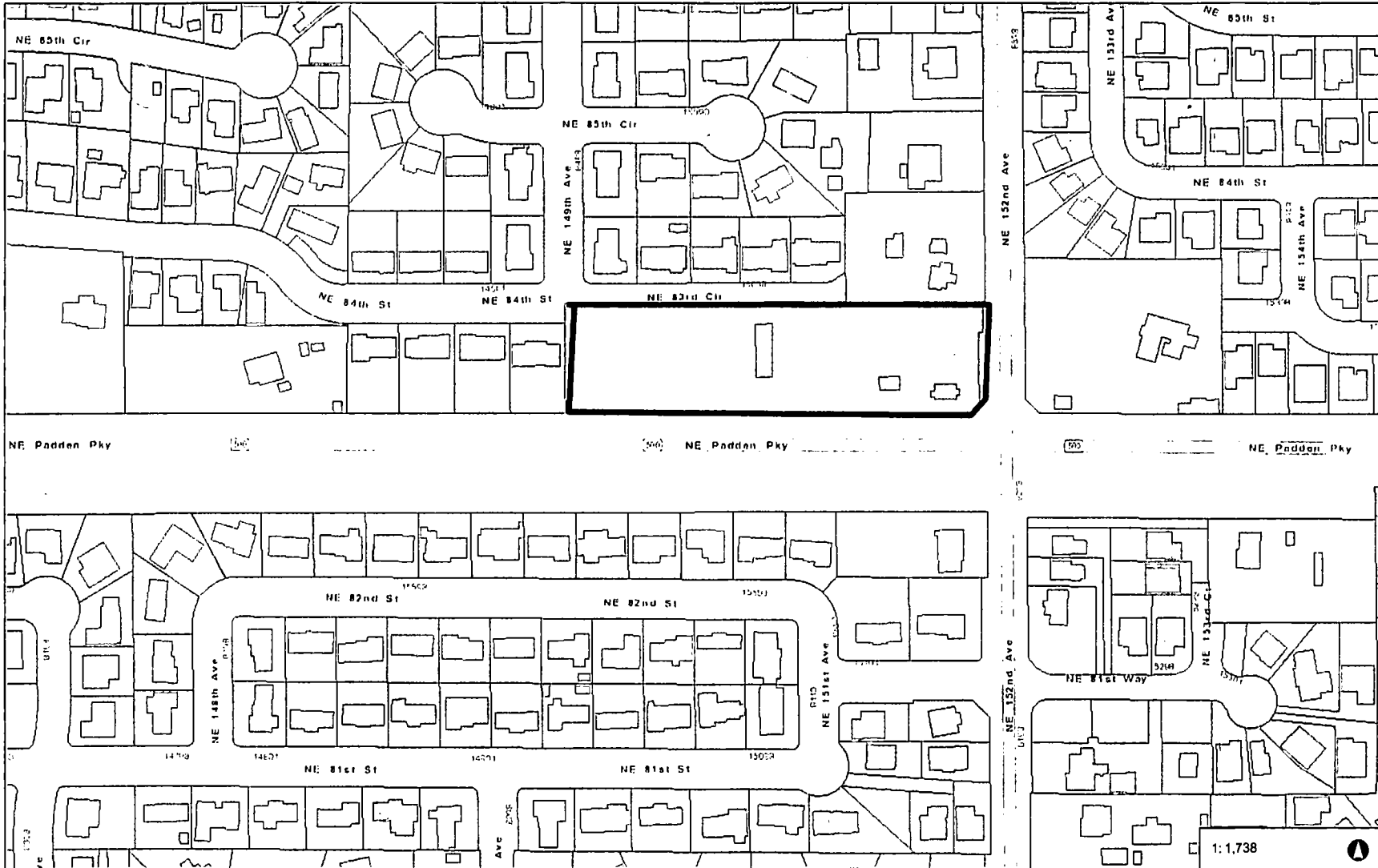
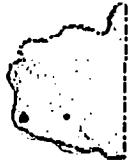

- Legend**
- Building Footprints
 - Taxlots
 - County Outline
 - World Street Map

Notes:

This map was generated by Clark County's "MapsOnline" website. Clark County does not warrant the accuracy, reliability or timeliness of any information on this map, and shall not be held liable for losses caused by using this information.

THIS MAP IS NOT TO BE USED FOR NAVIGATION

0.1 0 0.03 0.1 Miles

WGS_1984_Web_Mercator_Auxiliary_Sphere
Clark County, WA. GIS - <http://gis.clark.wa.gov>

This map was generated by Clark County's "MapsOnline" website. Clark County does not warrant the accuracy, reliability or timeliness of any information on this map, and shall not be held liable for losses caused by using this information.

THIS MAP IS NOT TO BE USED FOR NAVIGATION

