

**CLARK COUNTY
STAFF REPORT**

DEPARTMENT: Community Development
DATE: Final Plat Consent Agenda – February 8, 2016
REQUESTED ACTION: Acceptance of Plat Recording –
FLD2015-00029 Ashley Pointe PUD
 Consent Hearing County Manager

BACKGROUND

Transmitted for acceptance by the Councilors is the plat of: Ashley Pointe PUD FLD2015-00029; PLD2014-00024

Zoning: R1-20; **Lot Size:** The minimum lot area of 20,000 square feet and the maximum lot area of 30,000 square feet. **Actual Lot Size:** Parcels range in size from 10,001 square feet to 42,177 square feet. **Exceptions:** None; **Project Start:** The application vested on May 20, 2014, Pre-application conference was held May 20, 2014, Final order of Subdivision Review approval was February 27, 2015.

COMMUNITY OUTREACH

This proposed land division received the standard land use review and approval process. Notice of application was mailed to the applicant, the December 10, 2014, and property owners located within 300 feet of the site on December 10, 2014. A notice of hearing was posted on the site on December 17, 2014.

DISTRIBUTION:

Board staff will post all staff reports to The Grid. <http://www.clark.wa.gov/thegrid/>

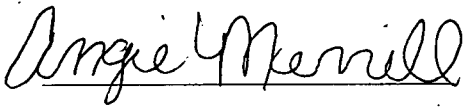

Planning Tech,
Angie Merrill

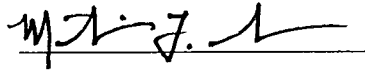

Director Community Development,
Marty Snell

APPROVED: 
CLARK COUNTY, WASHINGTON
BOARD OF COUNTY COUNCILORS

DATE: Feb. 9, 2016

SR 025-16

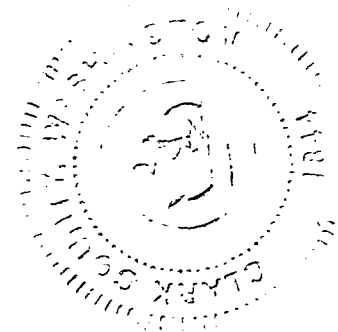

*msn
OK
N*



Vicinity Map

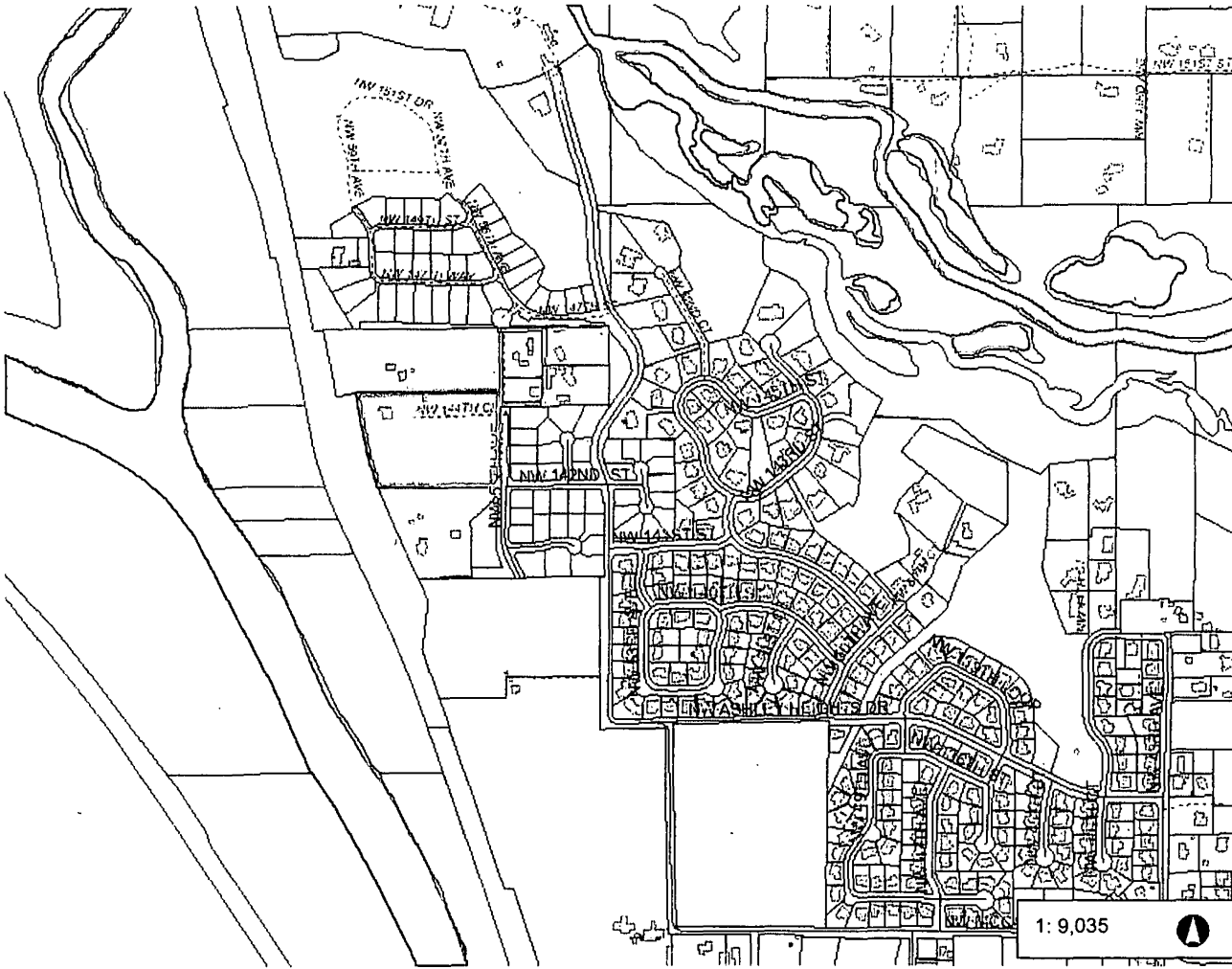

Legend

- Building Footprints
- Taxlots
- Cities Boundaries
- Urban Growth Boundaries

Notes:

1,505.9 0 752.93 1,505.9 Feet

WGS_1984_Web_Mercator_Auxiliary_Sphere
Clark County, WA, GIS - <http://gis.clark.wa.gov>

1: 9,035



This map was generated by Clark County's "MapsOnline" website. Clark County does not warrant the accuracy, reliability or timeliness of any information on this map, and shall not be held liable for losses caused by using this information.

